

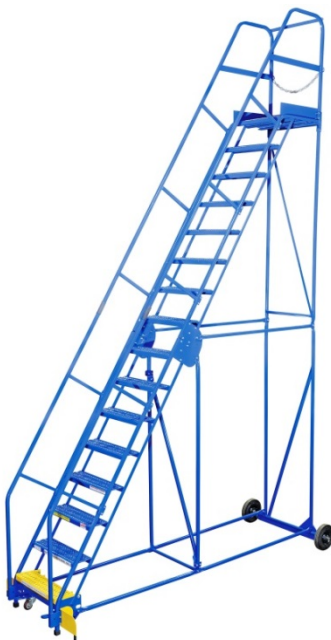

**Vestil Manufacturing Corp.**  
 2999 North Wayne Street, P.O. Box 507, Angola, IN 46703  
 Telephone: (260) 665-7586 -or- Toll Free (800) 348-0868  
 Fax: (260) 665-1339  
 Website: [www.vestilmfg.com](http://www.vestilmfg.com) e-Mail: [info@vestil.com](mailto:info@vestil.com)

## LAD-series Portable Warehouse Ladders, 13-16 Steps Instruction Manual



### Receiving Instructions

After delivery, remove the packaging from the product. Inspect the product closely to determine whether it sustained damage during transport. If damage is discovered, record a complete description of it on the bill of lading. If the product is undamaged, discard the packaging.

**NOTE:** The end-user is solely responsible for confirming that product design, use, and maintenance comply with laws, regulations, codes, and mandatory standards applied where the product is used.

### Technical Service & Replacement Parts

For answers to questions not addressed in these instructions and to order replacement parts, labels, and accessories, call our Technical Service and Parts Department at (260) 665-7586. The department can also be contacted online at [http://www.vestilmfg.com/parts\\_info.htm](http://www.vestilmfg.com/parts_info.htm).

### Electronic copies of Instruction Manuals

Additional copies of this instruction manual may be downloaded from <https://www.vestil.com/page-manuals.php>.

### Table of Contents

Signal Words.....	2
Safety Instructions.....	2
Specifications.....	3
FIGURES 1, 2, 3, 4, & 5: Exploded Parts Diagrams and Bills of Materials.....	4, 5, 6, 7, 8
Installing Casters.....	9
Assembling the Ladder.....	10, 11, 12, 13, 14
Record of Satisfactory Condition.....	15
National Standards.....	15
Using the Ladder.....	15
Inspections & Maintenance.....	15 - 16
Labeling Diagram.....	17
Limited Warranty.....	18

## SIGNAL WORDS

This manual uses SIGNAL WORDS to indicate the likelihood of personal injuries, as well as the probable seriousness of those injuries, if the product is misused in the ways described. Other signal words call attention to uses of the product likely cause property damage. The signal words used appear below along with the meaning of each word:



**Identifies a hazardous situation which, if not avoided, WILL result in DEATH or SERIOUS INJURY. Use of this signal word is limited to the most extreme situations.**



**Identifies a hazardous situation which, if not avoided, COULD result in DEATH or SERIOUS INJURY.**



**Identifies practices likely to result in product/property damage, such as operation that might damage the crane.**

## SAFETY INSTRUCTIONS

Vestil strives to identify foreseeable hazards associated with the use of its products. However, no manual can address every conceivable risk. The most effective way to avoid injury is to exercise sound judgment when assembling, using, inspecting, and maintaining this ladder. **Keep a copy of this manual with the ladder at all times.** For example, put the copy inside a plastic pouch and attach the pouch to the frame. **Anyone who uses this ladder must be made aware that a copy of the manual is available and where to find it.**



Improper or careless use could result in serious personal injuries or death.

- **Read and understand the entire manual before assembling, using, inspecting, or servicing the ladder.**
- **DO NOT use this ladder unless you are in good health. NEVER use the ladder while under the influence of alcohol or drugs, including prescription medication that affects balance, perception, or judgment.**
- DO NOT exceed the capacity/rated load. The total weight applied to the ladder (weight of the user plus tools, etc.) must not be greater than the capacity. The capacity is provided on label 287. See [Labeling Diagram](#) on p. 17.
- Wear appropriate footwear. DO NOT wear high-heeled shoes or footwear with smooth soles.
- DO NOT use the ladder on uneven, sloped, or unstable surfaces. **ONLY use the ladder on even, level, improved surfaces (concrete or asphalt).**
- Make sure that you will not contact overhead objects with either your body or with the ladder during use.
- Avoid electrical shock! Take precautions to prevent any contact, or possible contact, with an energized, insulated conductor (electrical line).
- Remove foreign matter, e.g. mud, from your shoes before walking on the ladder. Only wear slip-resistant shoes.
- Only stand on the steps. DO NOT climb on the railing. DO NOT slide on the railing.
- DO NOT access, or egress from, any step from another elevated surface unless the ladder is positively secured against movement.
- ALWAYS use the handrails while ascending or descending the ladder. Face the ladder while ascending it.
- DO NOT increase the height of a step by standing on other objects placed on the ladder.
- Inspect the ladder as described in [Inspections & Maintenance](#) on p. 15-16. DO NOT use the ladder unless it is in [Satisfactory Condition](#). ONLY use manufacturer-approved replacement parts when repairs are necessary.
- DO NOT use the ladder if either square cap (99-024-027) is worn. See applicable [Exploded View](#) on p. 4-8. Caps should prevent the ladder from sliding. Replace worn or damaged caps before using the ladder.
- ONLY use the ladder to access elevated working positions. DO NOT use the ladder for any other purpose. DO NOT store materials and/or equipment on the steps. Always unload the ladder before leaving it unattended.
- DO NOT position an occupied ladder in front of a door unless that door is secured in an open position, is locked, is attended, or is barricaded.
- DO NOT lean, or reach, over the side rails or handrails of the ladder. Position the ladder as close to the work as possible. Reposition the ladder to prevent overreaching. Overreaching could cause instability and result in a fall.
- Avoid sudden shifts while on the ladder.
- DO NOT push, pull, or lean on the handrails.
- DO NOT skip steps. Climb the ladder one step at a time.
- DO NOT attempt to move the ladder while someone is using it. The ladder must be unoccupied before it is moved.
- DO NOT use the ladder to transport people or objects. DO NOT ride on the ladder.
- DO NOT remove or obscure any label. Each label must be readable, undamaged, and present in the appropriate location. See [Labeling Diagram](#) on p. 17.
- DO NOT modify this ladder! Unauthorized modifications automatically void the [Limited Warranty](#) (p. 18) and might make the ladder unsafe to use.
- While assembling this ladder, confirm that only locking fasteners are provided, i.e. only locking nuts. Contact [Technical Service](#) (p. 1) if you find non-locking nuts. Only lock nuts should be used. However, lock nuts can only safely be used once. Discard the used lock nut and install a new lock nut after unfastening a connection.

## SPECIFICATIONS

Documents that provide specifications for LAD series mobile ladder stands are available online to anyone who visits the Vestil website. Specifications include dimensions, net weight, and capacity information. Acquire the appropriate specifications document by opening this webpage: <https://www.vestil.com/product.php?FID=602>. Click the "Specifications" tab. Scroll the page to the entry for the product you purchased. Click the button in the "PDF" column that looks like a pencil inside a blue-bordered box. A PDF file will open. This file is the specifications document. Print a copy of the document as soon as your ladder is delivered and keep it with your copy of this manual. If you encounter difficulties while trying to obtain a copy of the specifications document, contact [Technical Service](#). Contact information is provided on the cover page of this manual.

The following is an exemplar specifications document. In this case, it shows a LAD-13-14-G.

13-STEP ROLLING STEEL WAREHOUSE LADDER- LAD-13-14-G-EZ		APPROX WEIGHT: 386.64 lbs. DOES NOT INCLUDE WEIGHT OF POWER OR PACKAGING!!!	
*** ANY ADDITIONS, DELETIONS, OR OMISSIONS MUST BE CORRECTED ON THIS DRAWING AS THIS DRAWING WILL BE CONSIDERED ALL INCLUSIVE ***			
ALL GRAPHICS PROVIDED ARE FOR REFERENCE ONLY. IF CERTAIN DIMENSIONS ARE CRITICAL PLEASE VERIFY THOSE DIMENSIONS WITH YOUR SALESPERSON			
<b>STANDARD FEATURES</b> MODEL NUMBER IS LAD-13-14-G-EZ OVERALL WIDTH IS 42 1/4" USABLE WIDTH IS 23 9/16" OVERALL LENGTH IS 120 7/8" USABLE LENGTH IS 116 9/16" OVERALL HEIGHT IS 166" TOP STEP HEIGHT IS 130" STEP TYPE IS GRIP STRUT CLIMB ANGLE IS 50° STEP DEPTH IS 7" TOP STEP DEPTH IS 14" MAX CAPACITY IS 350 LBS WHEEL SIZE IS Ø10" FRONT WHEEL SIZE IS Ø3" TOUGH BAKED IN POWDER COATED BLUE FINISH BOTTOM STEP HAS TOUGH BAKED IN POWDER COATED YELLOW FINISH		<b>NOTE</b> SOME ASSEMBLY REQUIRED TOOL TRAY SOLD SEPARATELY SAFETY GATE SOLD SEPARATELY  <b>SPECIAL FEATURES</b> NONE	
<b>APPROVAL</b> I, THE UNDERSIGNED, AGREE THAT THE PRODUCT AS REPRESENTED SATISFIES DESIGN AND DIMENSION REQUIREMENTS. I ALSO ACKNOWLEDGE MY DUTY TO CONFIRM PRODUCT AND INSTALLATION COMPLIANCE WITH ALL APPLICABLE FEDERAL, STATE AND LOCAL REGULATIONS AND STANDARDS. <b>ANY MODIFIED UNITS ARE NON-RETURNABLE</b> <input type="checkbox"/> As drawn <input type="checkbox"/> As marked Signed: _____ Date: _____ Printed Name: _____ LEAD TIME WILL START UPON RECEIPT OF SIGNED APPROVAL DRAWING		DISTRIBUTOR'S NAME: <b>VESTIL MANUFACTURING</b> DRAWN BY: _____ DATE: _____ REFERENCE: <input checked="" type="checkbox"/> SCALE: 1:42 QUOTED LEAD TIME: <input checked="" type="checkbox"/> QUOTE # <input checked="" type="checkbox"/> P.O.# <input checked="" type="checkbox"/> W.O.# <input checked="" type="checkbox"/> SALES: <input checked="" type="checkbox"/> FILE NAME: 44-007-560	

**NOTE:** If your model is not included on the webpage, or if you cannot access and/or print the document, contact the [Technical Service Dept.](#) Contact information is provided on the front page of this manual.

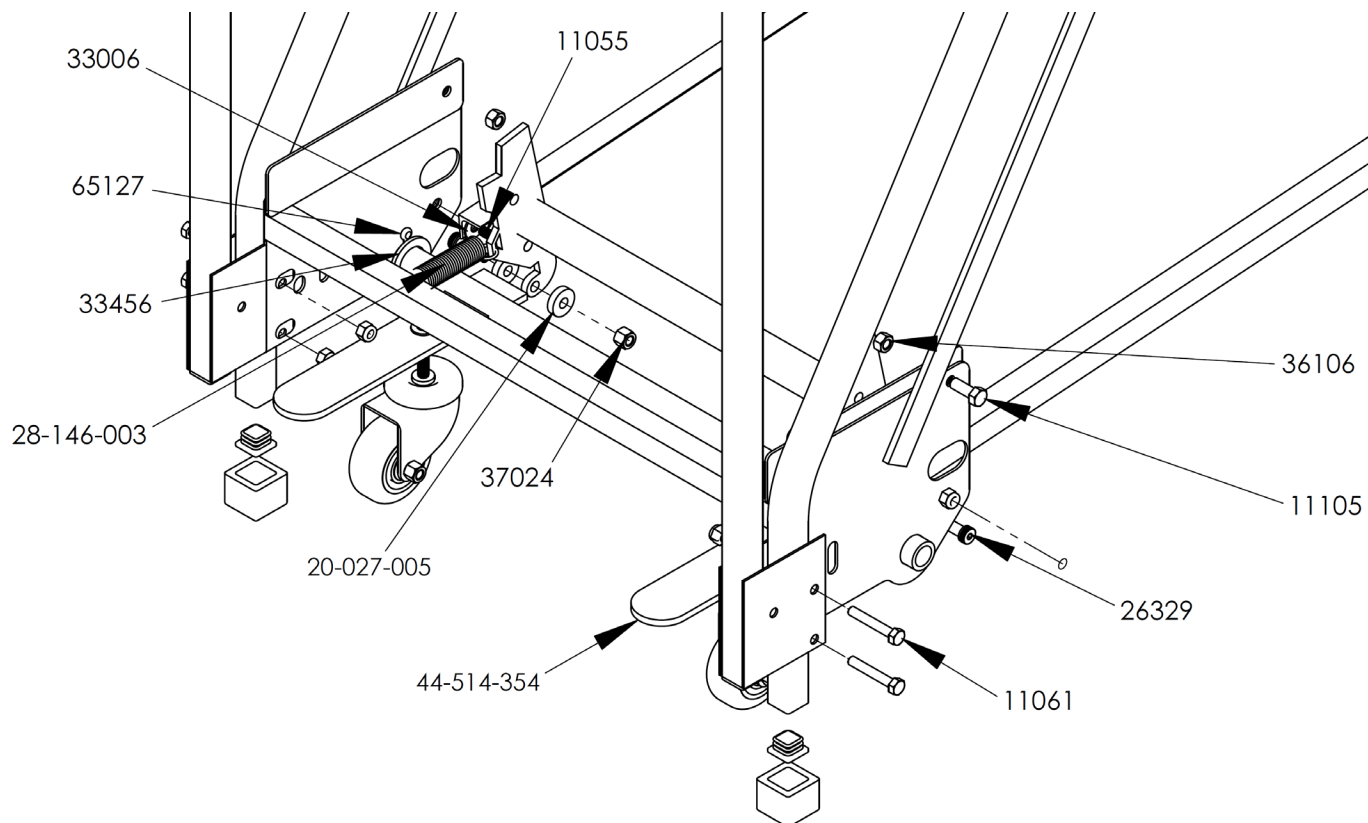
**FIG. 1: Foot Lock Mechanism Exploded View and Bill of Materials**

Part no.	Description	Quantity
11055	$\frac{5}{16}$ in. – 18 x 1in. HHCS #2 zinc-plated bolt	2
36106	$\frac{3}{8}$ in. – 16 zinc-plated hex nut	2
11105	$\frac{3}{8}$ in. – 16 x 1in. hex head bolt	2
26329	$\frac{3}{8}$ in. shoulder x $\frac{3}{4}$ in. x $\frac{5}{16}$ in. – 18	2
11061	$\frac{5}{16}$ in. – 18 x 2in. HHCS #2 zinc-plated bolt	4
44-514-354	Weldment, frame, castor pivot foot lock “caster bracket”	1
37024	$\frac{3}{8}$ in. Nylock insert nut	4
20-027-005	Roller guide	4
28-146-003	Spring	2
33456	1 $\frac{1}{8}$ in. I.D. 10 gauge machine bushing	2
65127	$\frac{3}{16}$ in. x 2in. zinc-plated cotter pin	2
33006	$\frac{5}{16}$ in. USS zinc-plated flat washer	2

**FIG. 2:** LAD-13-14-P-EZ, LAD-13-14-G-EZ, LAD-13-21-P-EZ, & LAD-13-21-G-EZ Exploded View and Bill of Materials (44-006-560)

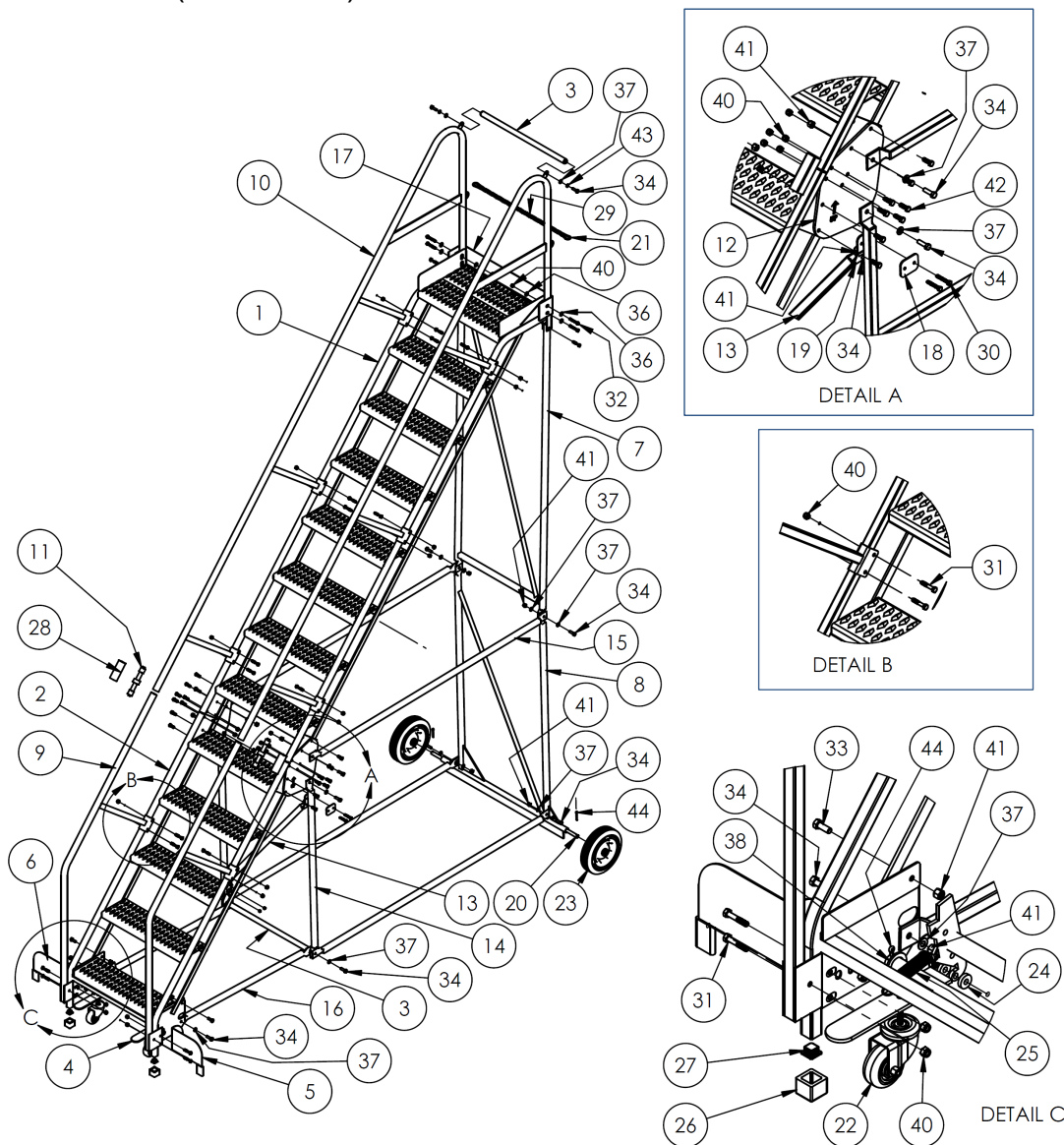

Also see FIG. 1 on p. 4

Item	Part no.	Description	Quantity
1	44-647-285	Weldment, step, 50°, top 8 steps:	1
	44-647-284	LAD-13-14-G-EZ	1
	44-647-286	LAD-13-14-P-EZ	1
	44-647-286	LAD-13-21-G-EZ	1
	44-647-287	LAD-13-21-P-EZ	1
2	44-647-277	Weldment, 13-step frame, bottom, 50°:	1
	44-647-276	LAD-13-14-G-EZ & LAD-13-21-G-EZ	1
3	44-514-314	LAD-13-14-P-EZ & LAD-13-21-P-EZ	1
3	44-514-314	Weldment, frame, back platform	2
4	44-514-354	Weldment, frame, caster pivot foot lock	1
5	44-514-399	Assembly, frame, outrigger, right	1
6	44-514-400	Assembly, frame, outrigger, left	1
7	44-514-401	Weldment, support frame, upper 8 steps	1
8	44-514-402	Weldment, support frame, lower 13 steps	1
9	44-524-158	Weldment, handrail, 50° climb, lower	2
10	44-524-162	Weldment, handrail, 50° climb, top 8 steps:	2
	44-524-163	LAD-13-14-G-EZ & LAD-13-14-P-EZ	2
		LAD-13-21-G-EZ & LAD-13-21-P-EZ	2
11	44-645-002	Assembly, handrail splice joint	2
12	44-012-008	Hinge plates, connector	2
13	44-014-601	Frame tube, horizontal, vertical center, crimped	1
14	44-014-593	Frame, tube, horizontal, vertical center, crimped:	2
15	44-014-605	Frame, tube, horizontal back, crimped	4
	44-014-606	LAD-13-14-G-EZ & LAD-13-14-P-EZ	4
		LAD-13-21-G-EZ & LAD-13-21-P-EZ	4
16	44-014-607	Frame, tube, horizontal, crimped	2
17	44-015-001	Toeuard, removable back formed, formed	1
18	44-016-109	Bracket, mid-ladder, outside	2
19	44-016-110	Bracket, mid-ladder, inside, formed	2
20	44-112-014	14-16 step wheel axle	1
21	08-145-008	1/4" snap hook	2
22	16-132-164	Caster, front	2
23	16-132-310	10" x 2 1/2" wheel with 16mm steel hub	2
24	20-027-005	Roller guide	4
25	28-146-003	Spring, release	2
26	99-024-027	1" x 1", 60 duro. square cap	2
27	99-025-025	1" plastic plug (black)	2
28	99-025-028	Grip, 1" square tube sleeve	2
29	99-145-031	3/16" chain, 24"	1
30	11010	1/4" - 20 x 1 3/4" HHCS #2 zinc-plated bolt	4
31	11060	5/16" - 18 x 1 1/4" HHCS hex bolt	22
32	11062	5/16" - 18 x 2 1/4" HHCS #2 zinc-plated bolt	4
33	11105	3/8" - 16 x 1 in. hex head bolt	2
34	11107	3/8" - 16 x 1 1/4" HHCS #2 zinc-plated bolt	16
35	26329	3/8" shoulder x 3/4" x 5/16" - 18 bolt	2
36	33006	5/16" USS zinc-plated USS flat washer	10
37	33008	3/8" zinc-plated USS flat washer	24
38	33456	1 1/8" I.D. 10 gauge machine bushing	2
39	37018	1/4" - 20 UNC zin-plated nylock nut	4
40	37021	5/16" - 18 zinc-plated #2 Nylon lock nut	46
41	37024	3/8" Nylock insert nut	16
42	11055	5/16" - 18 x 1" HHCS #2 zinc-plated bolt	18
43	33622	3/8" lock washer	2
44	65127	3/16" x 2" zinc-plated cotter pin	4

NOTE: See FIG. 1 on p. 4 for a detailed view of the Foot Lock Mechanism.



**FIG. 3:** LAD-14-14-G-EZ, LAD-14-14-P-EZ, LAD-14-21-G-EZ, & LAD-14-21-P-EZ Exploded View and Bill of Materials (44-006-564)

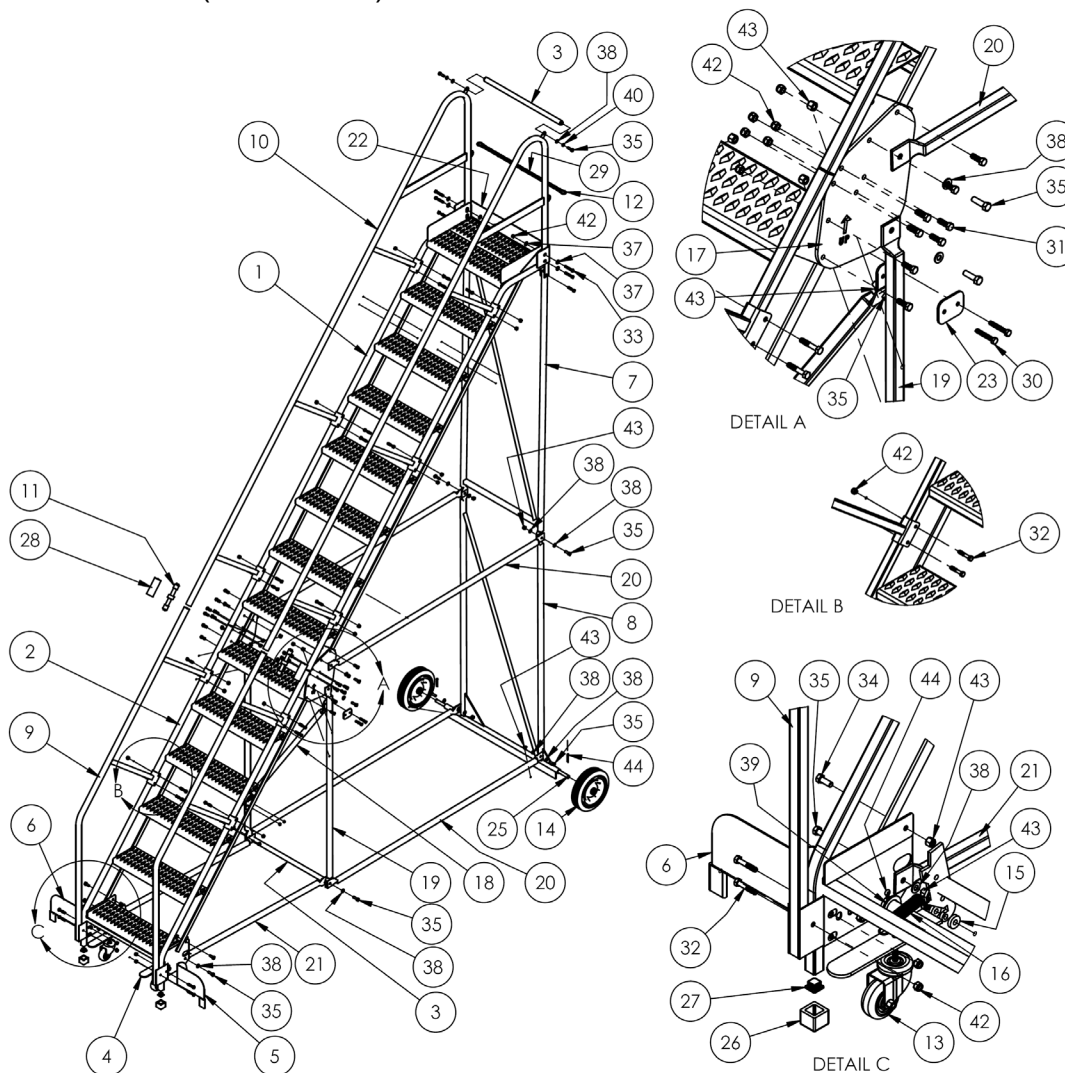

Also see FIG. 1 on p. 4

Item	Part no.	Description	Quantity
1	44-647-285	Weldment, step, 50°, top 8 steps:	1
	44-647-284	LAD-14-14-G-EZ	1
	44-647-286	LAD-14-14-P-EZ	1
	44-647-287	LAD-14-21-G-EZ	1
2	44-647-279	Weldment, 14-step frame, bottom, 50°:	1
	44-647-278	LAD-14-14-G-EZ & LAD-14-21-G-EZ	1
		LAD-14-14-P-EZ & LAD-14-21-P-EZ	1
3	44-514-314	Weldment, frame, back platform	2
4	44-514-354	Weldment, frame, caster pivot foot lock	1
5	44-514-399	Assembly, frame, outrigger, right	1
6	44-514-400	Assembly, frame, outrigger, left	1
7	44-514-401	Weldment, support frame, upper 8 steps	1
8	44-514-403	Weldment, support frame, lower 14 steps	1
9	44-524-159	Weldment, handrail, 50° climb, lower	2
10	44-524-162	Weldment, handrail, 50° climb, top 8 steps:	2
	44-524-163	LAD-14-14-G-EZ & LAD-14-21-G-EZ	2
11	44-645-001	Assembly, handrail splice joint	2
12	08-145-008	1/4" snap hook	2
13	16-132-164	Caster, front	2
14	16-132-310	10" x 2 1/2" wheel with 16mm steel hub	2
15	20-027-005	Roller guide	4
16	28-146-003	Spring, release	2
17	44-012-008	Hinge plates, connector	2
18	44-014-593	Frame, tube, horizontal, vertical center, crimped	1
19	44-014-594	Frame, tube, horizontal, vertical center, crimped	2
20	44-014-605	Frame, tube, horizontal back, crimped	4
	44-014-606	LAD-14-14-G-EZ & LAD-14-14-P-EZ	4
21	44-014-608	LAD-14-21-G-EZ & LAD-14-21-P-EZ	4
22	44-015-001	Frame, tube, horizontal, crimped	2
23	44-015-001	Toeguard, removable back formed, formed	1
24	44-016-109	Bracket, mid-ladder, outside	2
25	44-016-110	Bracket, mid-ladder, inside, formed	2
26	44-112-014	14-16 step wheel axle	1
27	99-024-027	1" x 1", 60 duro. square cap	2
28	99-025-025	1" plastic plug (black)	2
29	99-025-028	Grip, 1" square tube sleeve	2
30	99-145-031	3/16" chain, 24"	1
31	11010	5/16" - 20 x 1 3/4" HHCS #2 zinc-plated bolt	4
32	11055	5/16" - 18 x 1" HHCS #2 zinc-plated bolt	18
33	11060	5/16" - 18 x 1 3/4" HHCS hex bolt	26
34	11062	5/16" - 18 x 2 1/4" HHCS #2 zinc-plated bolt	4
35	11105	3/8" - 16 x 1 in. hex head bolt	2
36	11107	3/8" - 16 x 1 1/4" HHCS #2 zinc-plated bolt	16
37	26329	3/8" shoulder x 3/4" x 5/16" - 18 bolt	2
38	33006	5/16" USS zinc-plated USS flat washer	10
39	33008	3/8" zinc-plated USS flat washer	24
40	33456	1 1/8" I.D. 10 gauge machine bushing	2
41	33622	3/8" lock washer	2
42	37018	1/4" - 20 UNC zin-plated nylock nut	4
43	37021	5/16" - 18 zinc-plated #2 Nylon lock nut	50
44	37024	3/8" Nylock insert nut	16
45	65127	3/16" x 2" zinc-plated cotter pin	4

NOTE: See FIG. 1 on p. 4 for a detailed view of the Foot Lock Mechanism

**FIG. 4:** LAD-15-14-P-EZ, LAD-15-14-G-EZ, LAD-15-21-P-EZ, & LAD-15-21-G-EZ Exploded View and Bill of Materials (44-006-568)

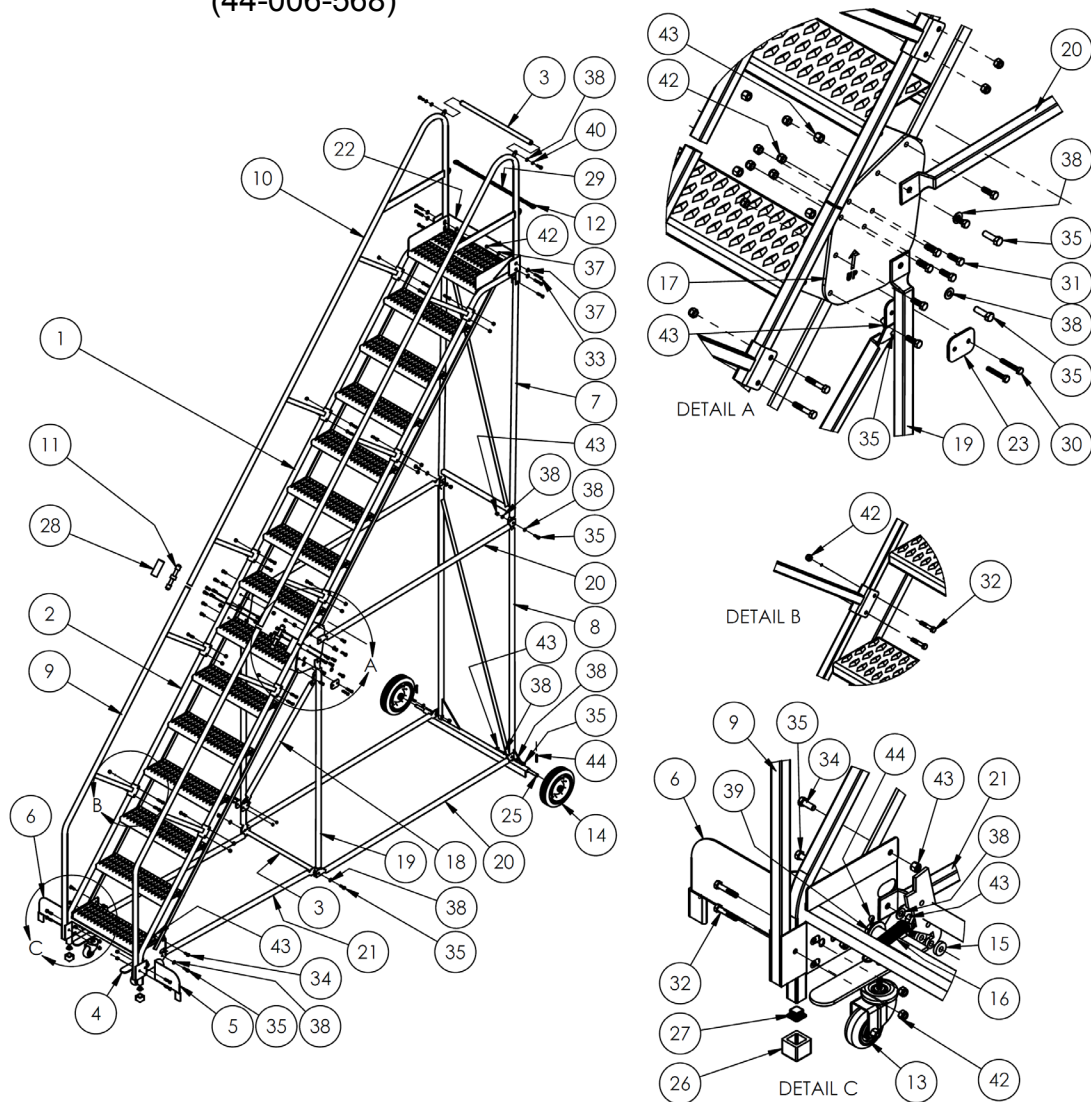

Also see FIG. 1 on p. 4

Item	Part no.	Description	Quantity
1	44-647-285	Weldment, step, 50°, top 8 steps:	1
	44-647-284	LAD-15-14-G-EZ	1
	44-647-286	LAD-15-14-P-EZ	1
	44-647-287	LAD-15-21-G-EZ	1
	44-647-287	LAD-15-21-P-EZ	1
2	44-647-281	Weldment, 15-step frame, bottom, 50°:	1
	44-647-280	LAD-15-14-G-EZ & LAD-15-21-G-EZ	1
3	44-514-314	Weldment, frame, back platform	2
4	44-514-354	Weldment, frame, caster pivot foot lock	1
5	44-514-399	Assembly, frame, outrigger, right	1
6	44-514-400	Assembly, frame, outrigger, left	1
7	44-514-401	Weldment, support frame, upper 8 steps	1
8	44-514-404	Weldment, support frame, lower 15 steps	1
9	44-524-160	Weldment, handrail, 50° climb, lower, 15 steps	2
10	44-524-162	Weldment, handrail, 50° climb, top 8 steps:	2
	44-524-163	LAD-15-14-G-EZ & LAD-15-14-P-EZ	2
11	44-524-163	LAD-15-21-G-EZ & LAD-15-21-P-EZ	2
	44-645-002	Assembly, handrail splice joint	2
12	08-145-008	1/4" snap hook	2
13	16-132-164	Caster, front	2
14	16-132-310	10" x 2 1/2" wheel with 16mm steel hub	2
15	20-027-005	Roller guide	4
16	28-146-003	Spring, release	2
17	44-012-008	Hinge plates, connector	2
18	44-014-594	Frame, tube, horizontal, vertical center, crimped	1
19	44-014-595	Frame, tube, horizontal, vertical center, crimped	2
20	44-014-605	Frame, tube, horizontal back, crimped	4
	44-014-606	LAD-15-14-G-EZ & LAD-15-14-P-EZ	4
21	44-014-609	LAD-15-21-G-EZ & LAD-15-21-P-EZ	4
	44-014-609	Frame, tube, horizontal, crimped	2
22	44-015-001	Toeuard, removable back formed, formed	1
23	44-016-109	Bracket, mid-ladder, outside	2
24	44-016-110	Bracket, mid-ladder, inside, formed	2
25	44-112-014	14-16 step wheel axle	1
26	99-024-027	1" x 1", 60 duro. square cap	2
27	99-025-025	1" plastic plug (black)	2
28	99-025-028	Grip, 1" square tube sleeve	2
29	99-145-031	3/16" chain, 24"	1
30	11010	1/4" - 20 x 1 3/4" HHCS #2 zinc-plated bolt	4
31	11055	3/16" - 18 x 1" HHCS #2 zinc-plated bolt	18
32	11060	5/16" - 18 x 1 3/4" HHCS hex bolt	26
33	11062	5/16" - 18 x 2 1/4" HHCS #2 zinc-plated bolt	4
34	11105	3/8" - 16 x 1 in. hex head bolt	2
35	11107	3/8" - 16 x 1 1/4" HHCS #2 zinc-plated bolt	16
36	26329	3/8" shoulder x 3/4" x 3/16" - 18 bolt	2
37	33006	5/16" USS zinc-plated USS flat washer	10
38	33008	3/8" zinc-plated USS flat washer	24
39	33456	1 1/8" I.D. 10 gauge machine bushing	2
40	33622	3/8" lock washer	2
41	37018	1/4" - 20 UNC zin-plated nylock nut	4
42	37021	3/16" - 18 zinc-plated #2 Nylon lock nut	50
43	37024	3/8" Nylock insert nut	16
44	65127	3/16" x 2" zinc-plated cotter pin	4

NOTE: See FIG. 1 on p. 4 for a detailed view of the Foot Lock Mechanism.

**FIG. 5:** LAD-16-14-P-EZ, LAD-16-14-G-EZ, LAD-16-21-P-EZ, & LAD-16-21-G-EZ Exploded View and Bill of Materials (44-006-572)

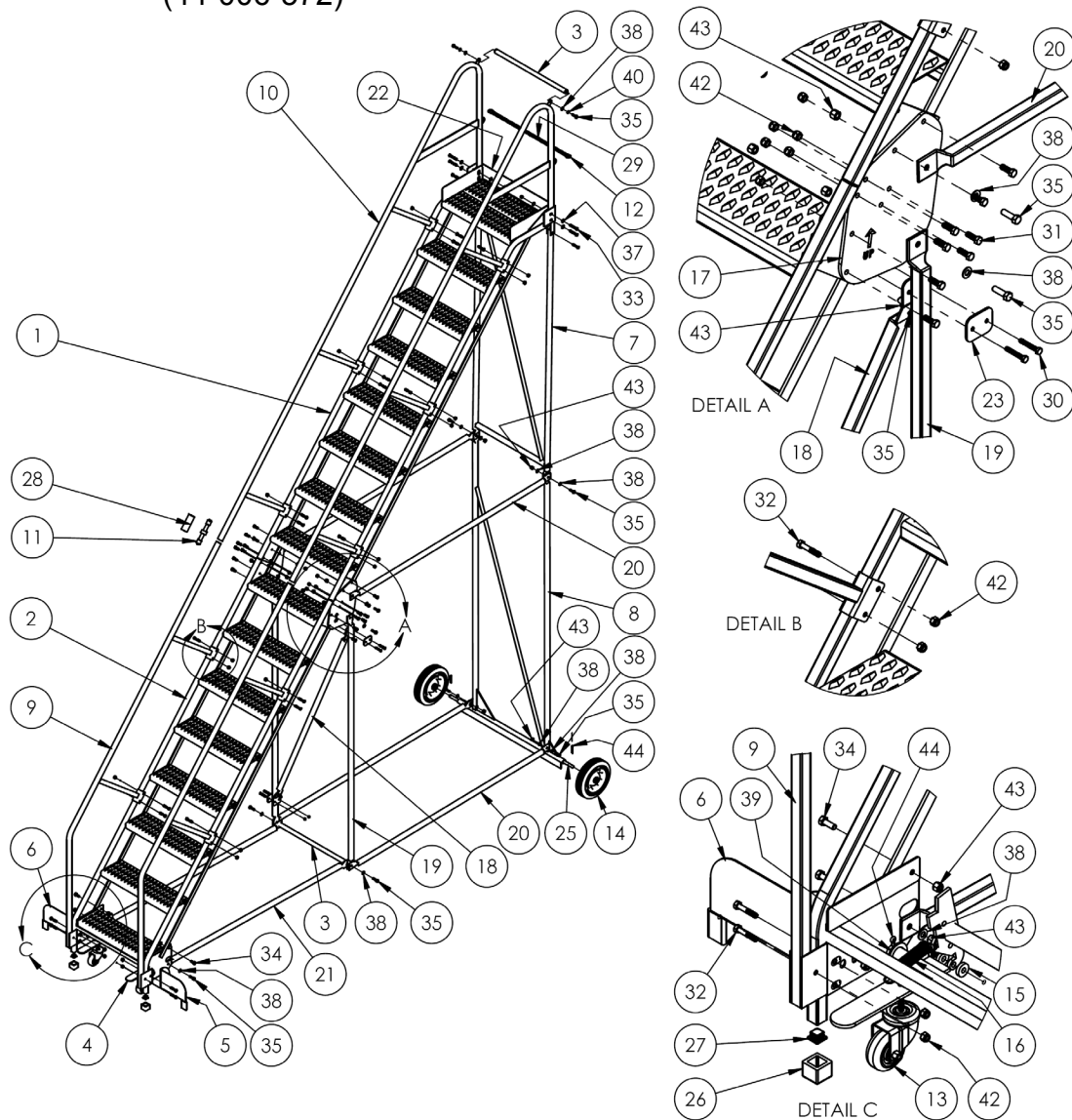

Also see FIG. 1 on p. 4

Item	Part no.	Description	Quantity
1	44-647-285	Weldment, step, 50°, top 8 steps:	1
	44-647-284	LAD-16-14-G-EZ	1
	44-647-286	LAD-16-21-G-EZ	1
	44-647-287	LAD-16-21-P-EZ	1
	44-647-283	LAD-16-14-P-EZ	1
2	44-647-283	Weldment, 16-step frame, bottom, 50°:	1
	44-647-282	LAD-16-14-P-EZ & LAD-16-21-P-EZ	1
3	44-514-314	Weldment, frame, back platform	2
4	44-514-354	Weldment, frame, caster pivot foot lock	1
5	44-514-399	Assembly, frame, outrigger, right	1
6	44-514-400	Assembly, frame, outrigger, left	1
7	44-514-401	Weldment, support frame, upper 8 steps	1
8	44-514-405	Weldment, support frame, lower 16 steps	1
9	44-524-161	Weldment, handrail, 50° climb, lower, 16 steps	2
10	44-524-162	Weldment, handrail, 50° climb, top 8 steps:	2
	44-524-163	LAD-16-14-G-EZ & LAD-16-14-P-EZ	2
11	44-524-163	LAD-16-21-G-EZ & LAD-16-21-P-EZ	2
	44-645-002	Assembly, handrail splice joint	2
12	08-145-008	1/4" snap hook	2
13	16-132-164	Caster, front	2
14	16-132-310	10" x 2 1/2" wheel with 16mm steel hub	2
15	20-027-005	Roller guide	4
16	28-146-003	Spring, release	2
17	44-012-008	Hinge plates, connector	2
18	44-014-595	Frame, tube, horizontal, vertical center, crimped	1
19	44-014-596	Frame, tube, horizontal, vertical center, crimped	2
20	44-014-605	Frame, tube, horizontal back, crimped	4
	44-014-606	LAD-16-14-G-EZ & LAD-16-14-P-EZ	4
21	44-014-610	LAD-16-21-G-EZ & LAD-16-21-P-EZ	4
	44-014-610	Frame, tube, horizontal, crimped	2
22	44-015-001	Toeguard, removable back formed, formed	1
23	44-016-109	Bracket, mid-ladder, outside	2
24	44-016-110	Bracket, mid-ladder, inside, formed	2
25	44-112-014	14-16 step wheel axle	1
26	99-024-027	1" x 1", 60 duro. square cap	2
27	99-025-025	1" plastic plug (black)	2
28	99-025-028	Grip, 1" square tube sleeve	2
29	99-145-031	3/16" chain, 24"	1
30	11010	1/4" - 20 x 1 3/4" HHCS #2 zinc-plated bolt	4
31	11055	3/16" - 18 x 1" HHCS #2 zinc-plated bolt	18
32	11060	5/16" - 18 x 1 3/4" HHCS hex bolt	26
33	11062	5/16" - 18 x 2 1/4" HHCS #2 zinc-plated bolt	4
34	11105	3/8" - 16 x 1in. hex head bolt	2
35	11107	3/8" - 16 x 1 1/4" HHCS #2 zinc-plated bolt	16
36	26329	3/8" shoulder x 3/4" x 5/16" - 18 bolt	2
37	33006	3/16" USS zinc-plated USS flat washer	10
38	33008	3/8" zinc-plated USS flat washer	24
39	33456	1 1/8" I.D. 10 gauge machine bushing	2
40	33622	3/8" lock washer	2
41	37018	1/4" - 20 UNC zin-plated nylock nut	4
42	37021	3/16" - 18 zinc-plated #2 Nylon lock nut	50
43	37024	3/8" Nylock insert nut	16
44	65127	3/16" x 2" zinc-plated cotter pin	4

NOTE: See FIG. 1 on p. 4 for a detailed view of the Foot Lock Mechanism



## INSTALLING CASTERS

1. Gather the lower step weldment, stem casters (16-132-164), 2 lock nuts (37024), and 2 flat washers (33008). Apply a permanent thread bonding and sealing compound like Loctite® Threadlocker Red 271™ to the threads of one of the stem casters (16-132-164). Follow the directions provided with the thread compound.
2. Insert the (threaded) stem of a caster into the hole in a caster bracket.
3. Put a  $\frac{3}{8}$ " flat washer (33008) over the stem.
4. Tighten a  $\frac{3}{8}$ "-16 lock nut (37024) on the stem.
5. Repeat steps 1-4 with the remaining caster. Install the caster in the other caster bracket.

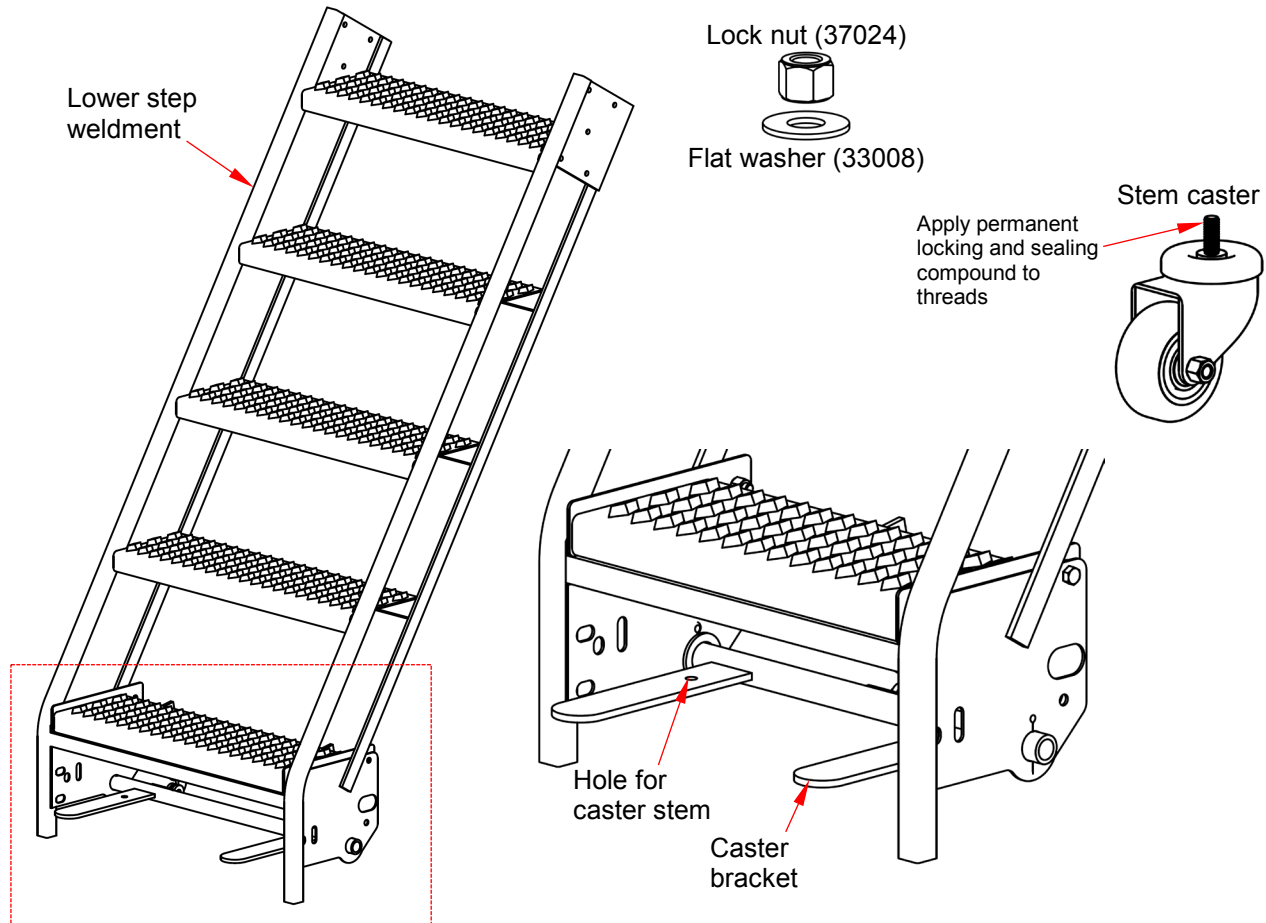

Step 2: Insert caster stem

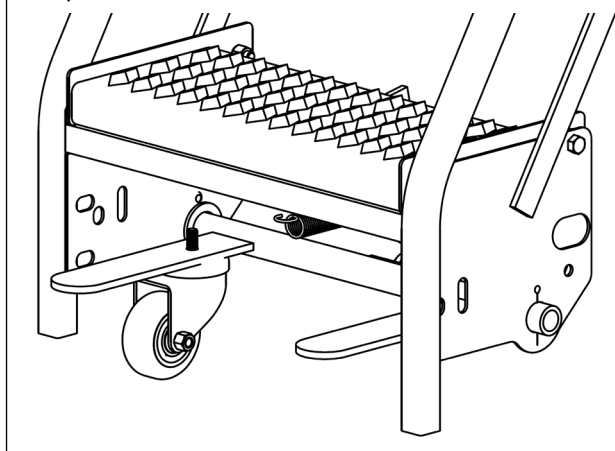

Step 4: Fasteners installed and tightened

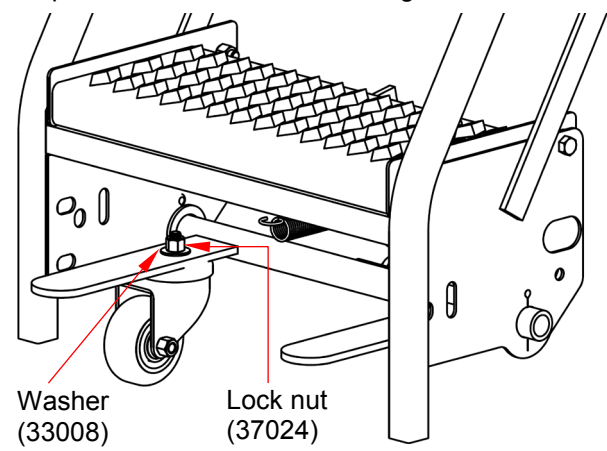

## ASSEMBLING THE LADDER (AT LEAST 2 PERSONS ARE NEEDED)

### **⚠ WARNING**

Improper assembly might make this ladder unsafe to use.

- Visually inspect all ladder components immediately after delivery and *before* assembling the ladder for damage that might have occurred during shipping. DO NOT assemble or use the ladder stand if you notice any damage to one or more of the steps or to other structural element (step weldment, back leg weldment, base supports, and handrails) of the ladder. Using the ladder stand with a weakened frame member could result in serious personal injuries.
- DO NOT assemble the ladder by yourself. Work with at least 1 other person to assemble the ladder.
- **Read the entire instruction manual before assembling this ladder.**

The following tools are necessary to assemble the ladder: a) 2 crescent wrenches ( $\frac{5}{16}$ " and  $\frac{3}{8}$ "); b) Rubber mallet.

Numbers in the diagrams and in parentheses ( ) correspond to item numbers or part numbers in the bills of materials on [pages 4, 5, 6, 7, & 8](#). Refer to the appropriate exploded view and bill of materials for your ladder while assembling it. NOTE: Step 1 depicts the step frame weldment with casters already installed. If your ladder is delivered without these casters installed, go to [INSTALLING CASTERS](#) on [p. 9](#). Install the casters; then proceed to step 1.

**Step 1:** Attach the upper (1) and lower (2) stair weldments using hinge plates (11) using  $\frac{5}{16}$ " – 18 hardware as shown in the illustration below. Install bolts through the bolt holes in the hinge plates and the hinge brackets highlighted with arrows. Insert bolts through holes **a-d** to connect the hinge plate to the upper step weldment; bolt holes **e-h** are used to fasten the hinge plate to the lower step weldment. Next, install the plastic plugs and square caps in the front legs. First, press the 1in. plastic plug into the front legs. Then, press the square caps over the plugs and onto the ends of the legs. If necessary, use a rubber mallet to gently tap the plugs and caps into place.

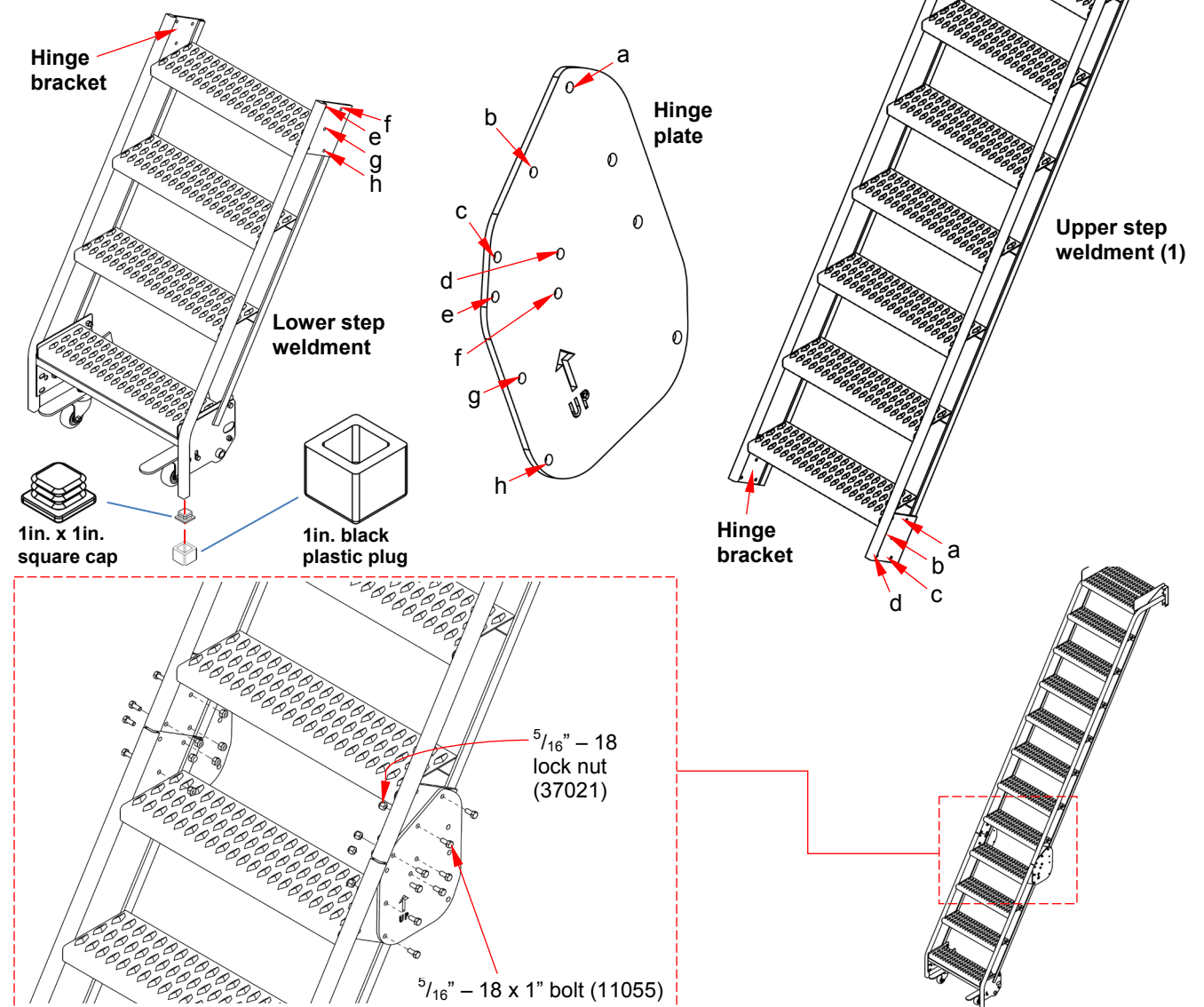

**Step 2:** Fasten the upper (44-514-401) and lower [44-514-405 (16-step models); 44-514-404 (15-steps); 44-514-403 (14-steps); 44-514-402 (13-steps)] step support weldments together and to the step assembly with  $\frac{5}{16}$  in. and  $\frac{3}{8}$  in. hardware. Be sure to orient the back leg weldment as shown below, with base brackets facing the bottom of the stairs. Only finger tighten the hardware.

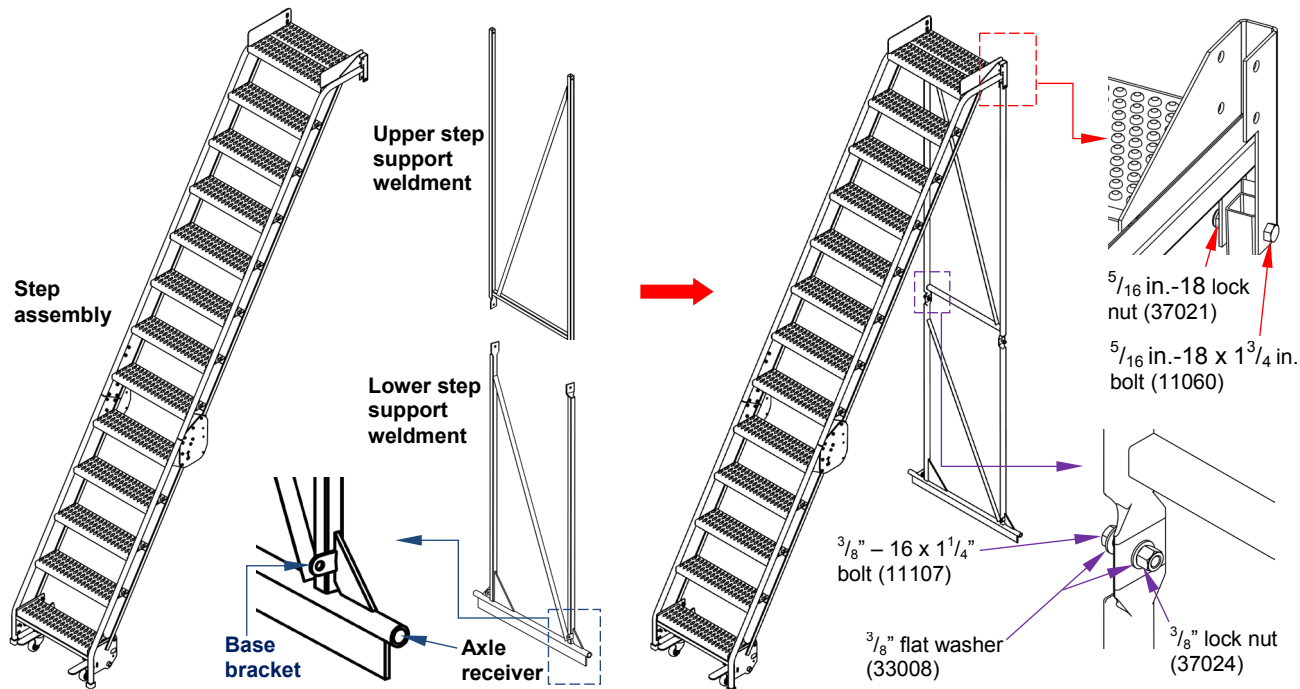

**Step 3:** Fasten the front vertical supports [44-014-593 (13-steps); 44-014-594 (14-steps); 44-014-595 (15-steps); 44-014-596 (16-step models)] and two horizontal supports (44-014-605 or 44-014-606) to the ladder assembly at points A, B, and C as shown in the diagram below with  $\frac{3}{8}$  in. hardware (11107; 33008; 37024).

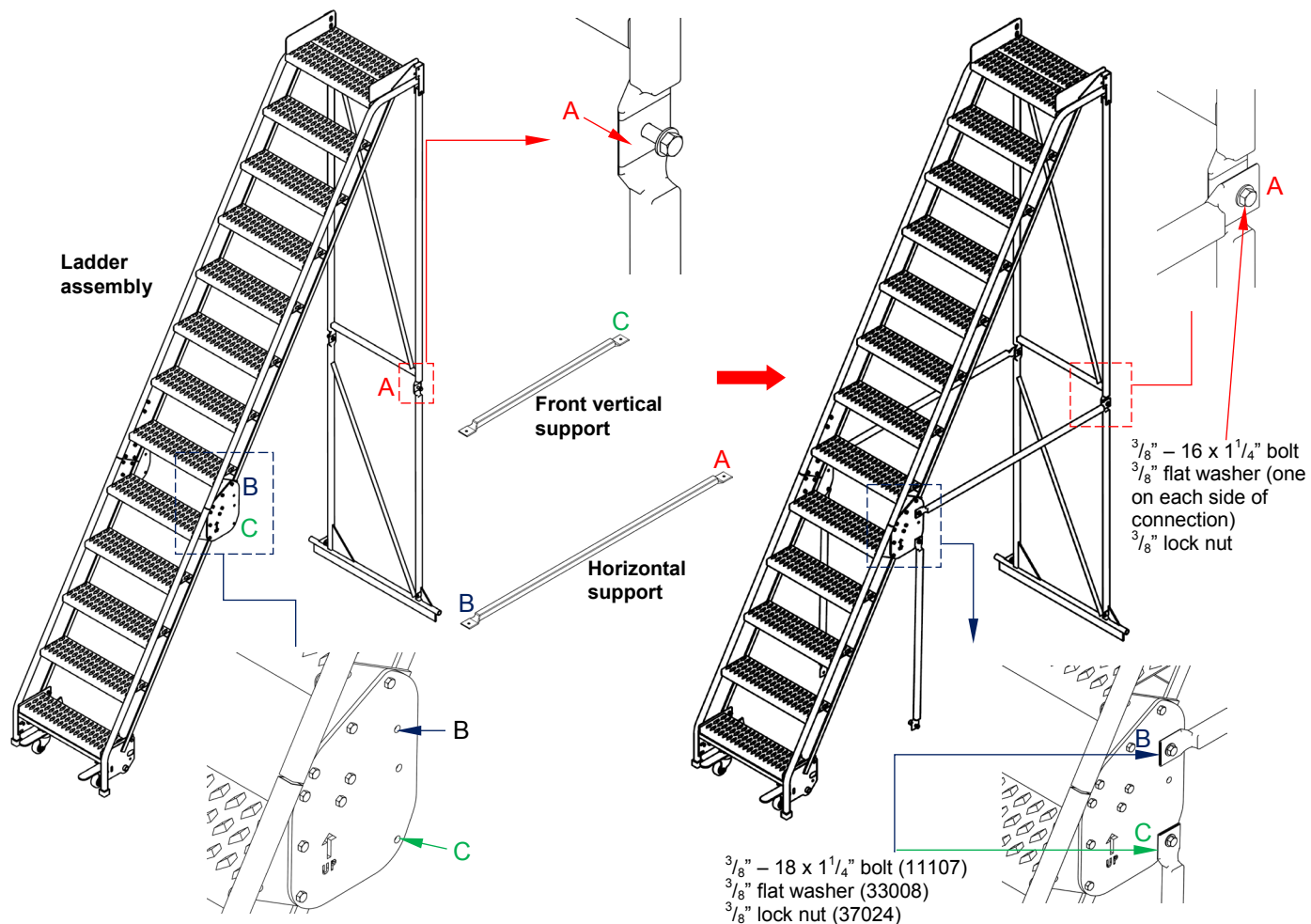



**Step 4:** Attach two more horizontal braces (44-014-605 or 44-014-606), the two front horizontal braces [44-014-607 (13 step models); 44-014-608 (14-steps); 44-014-609 (15-steps); 44-014-610 (16-steps)], and one of the threaded cross braces (44-514-314) to the ladder assembly with  $\frac{3}{8}$ " fasteners (11107; 33008; 37024) as diagrammed below.

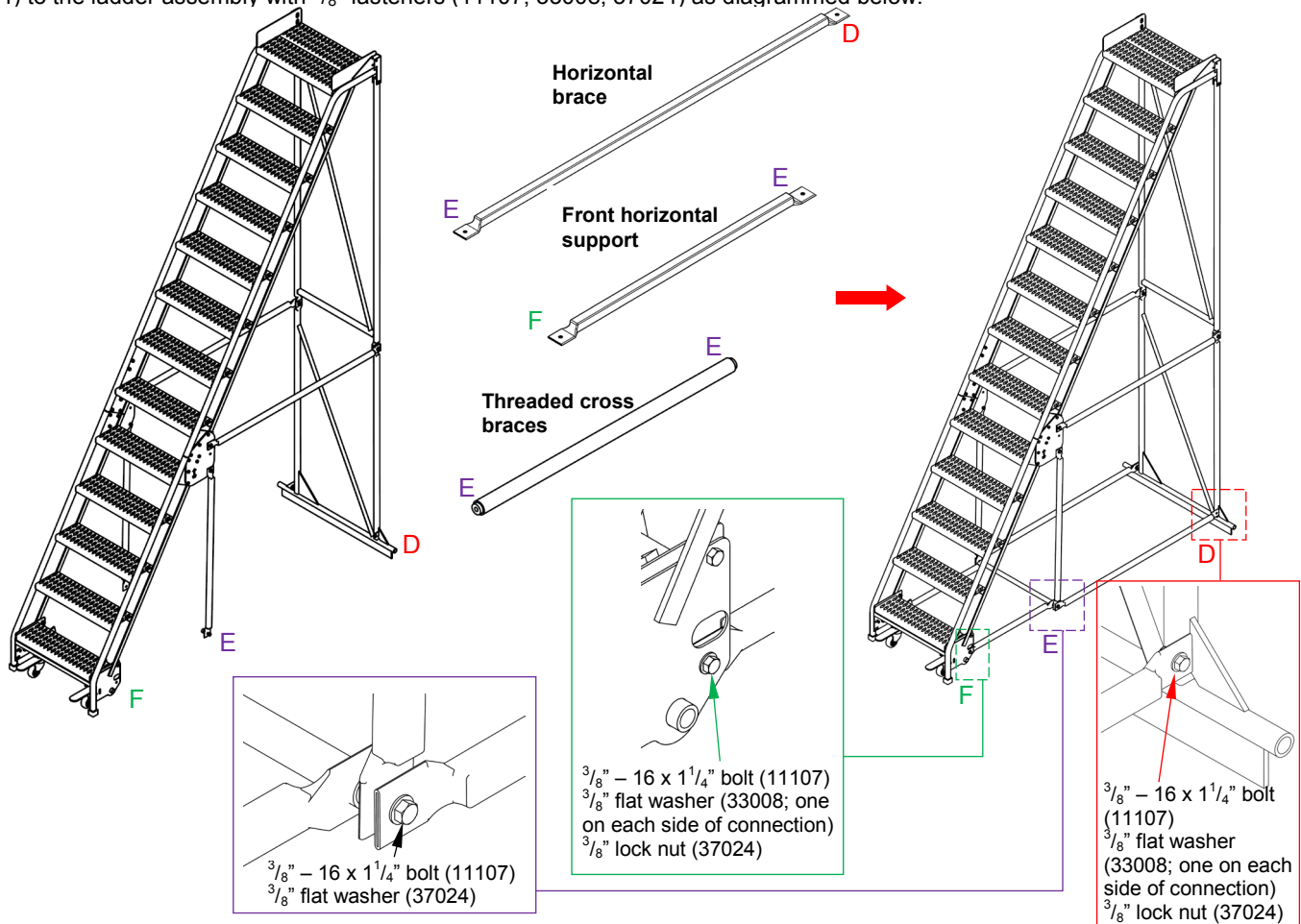

**Step 5:** Attach the diagonal frame brace [44-014-601 (13-step models); 44-014-593 (14-step models); 44-014-594 (15-step models); 44-014-595 (16 step models)] to the front vertical supports. First, fasten the diagonal frame brace to the formed brace bracket (44-016-110); then attach the formed bracket to the flat bracket (44-016-109) as shown in the diagram below.

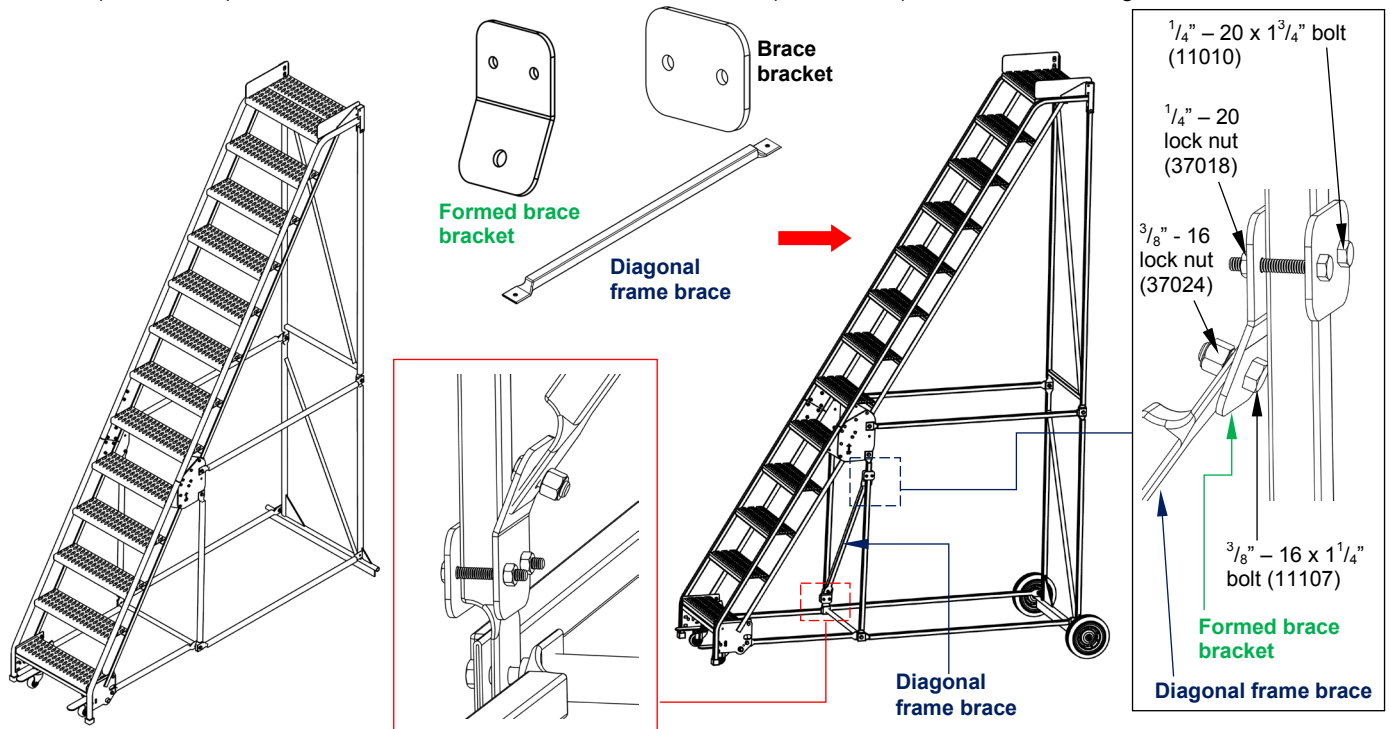



**Step 6:** Install the axle (44-112-014) and attach the wheels (16-132-310).

- Insert the axle through the axle receiver of the lower step support weldment.
- Slide the wheels onto the ends of the axle. Secure the wheels to the axle by inserting a cotter pin through the pinhole in each end of the axle. Periodically lubricate the axle to allow the wheels to rotate freely.

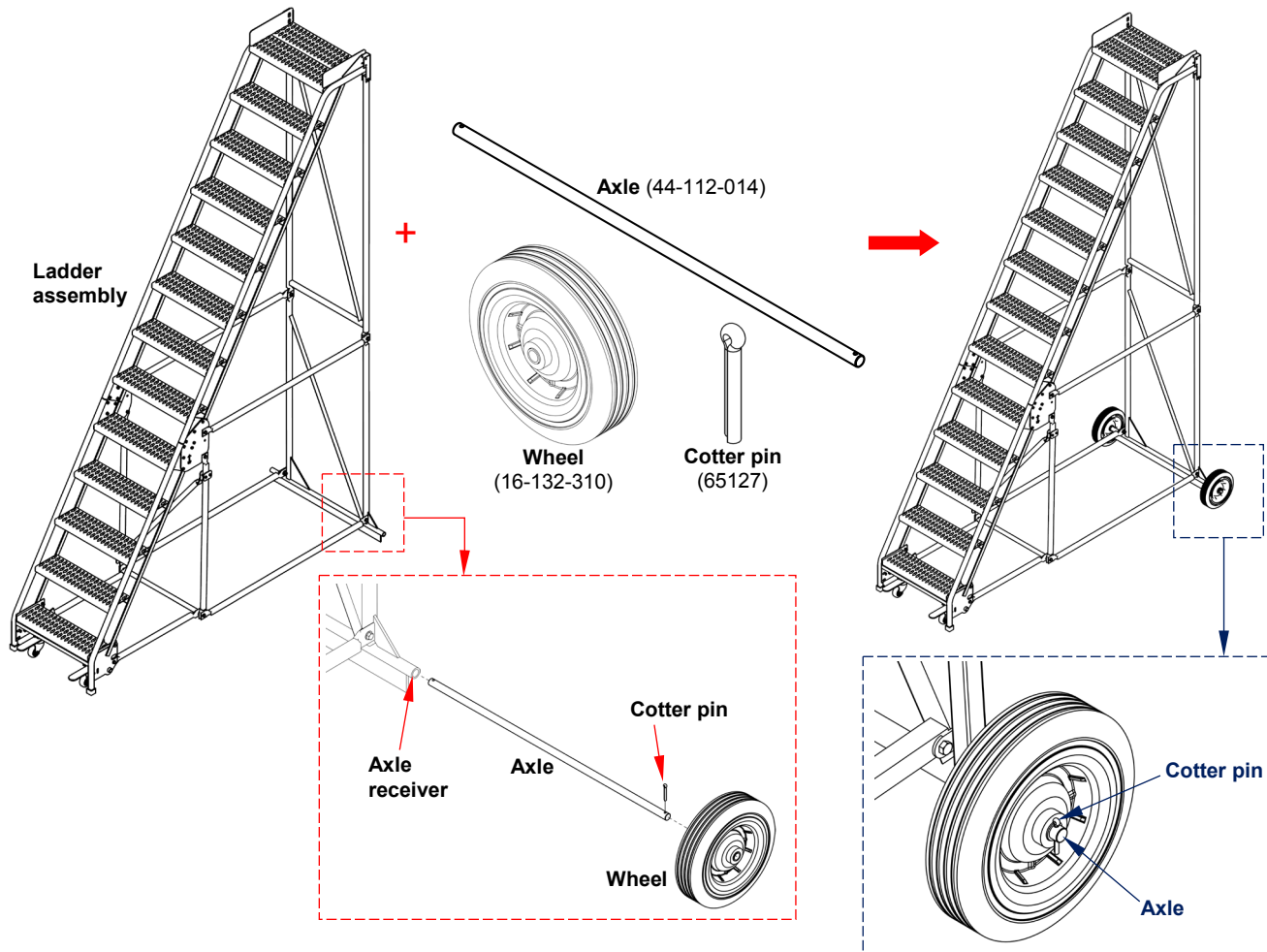
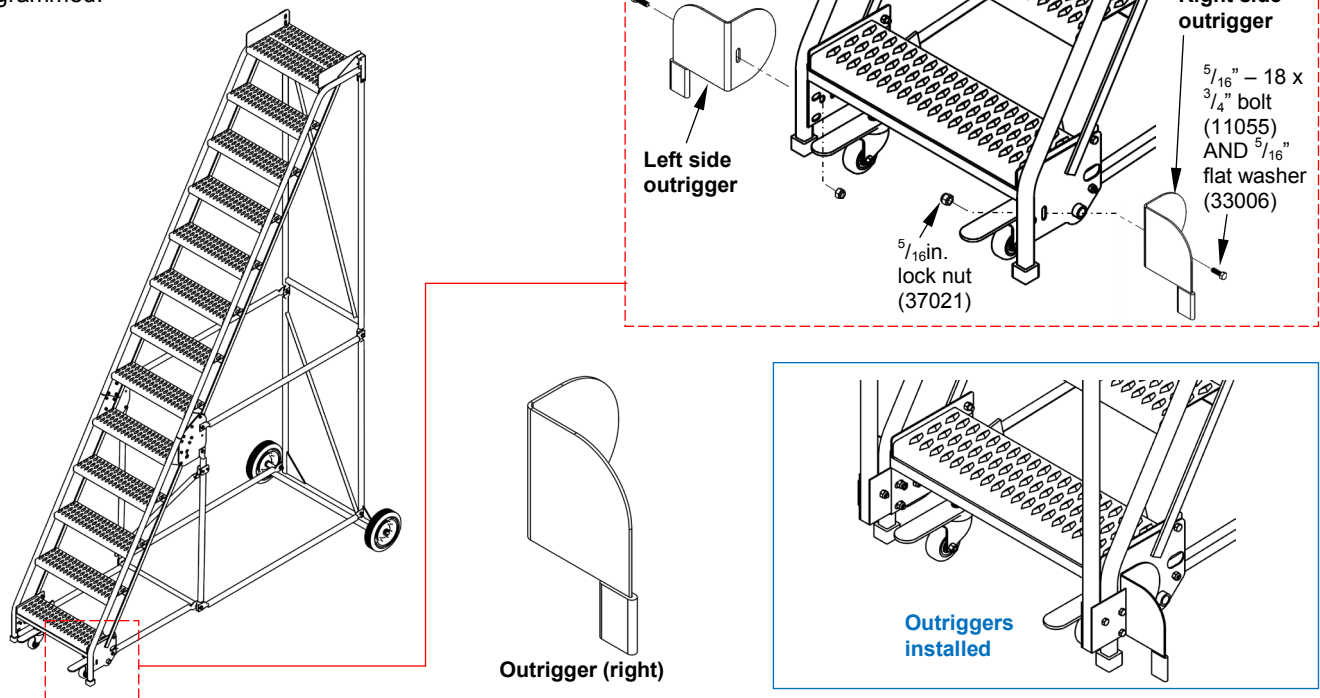
**Step 7:** Install the outriggers (44-514-399 & 44-514-400) as diagrammed.

**Step 8:** Install the toeboard at the top of the ladder; then set the ladder upright. The ladder is quite heavy and requires at least 2 people to lift it.

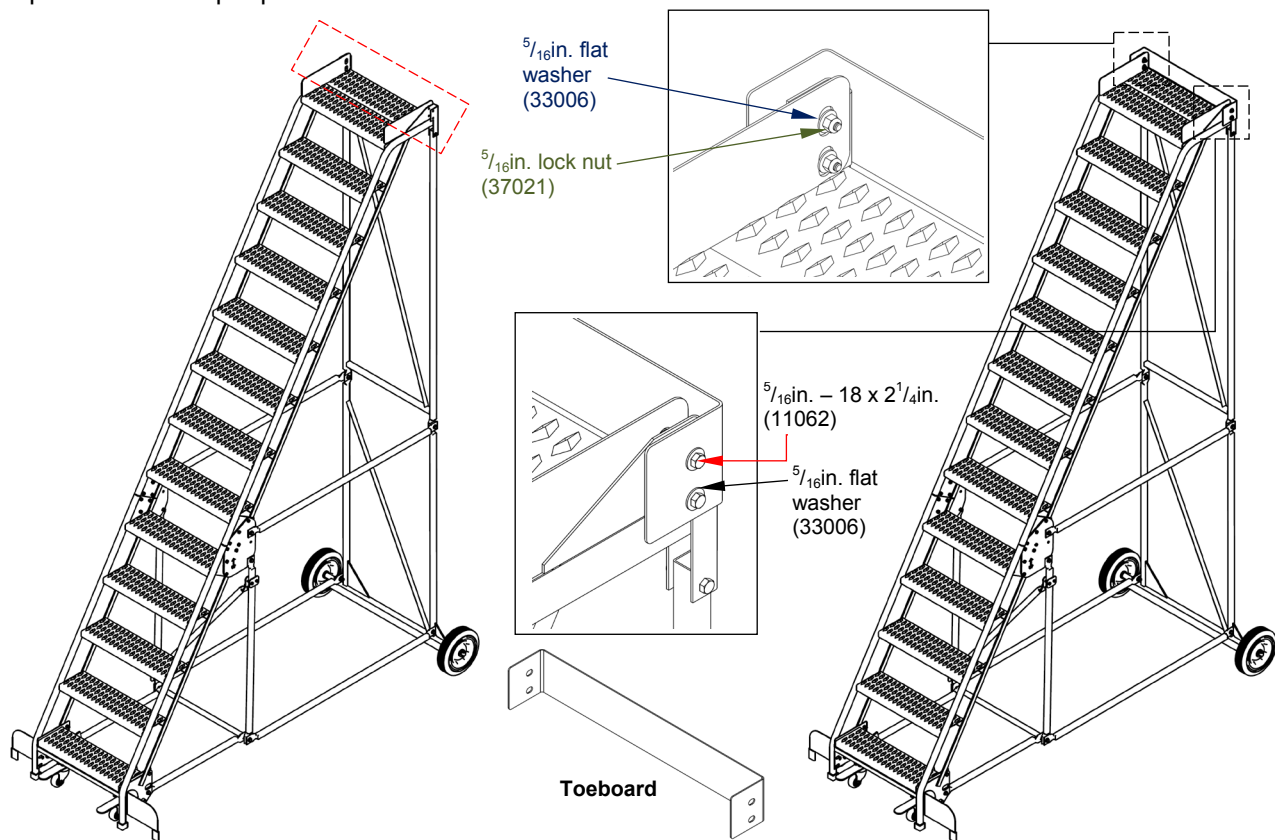

**Step 9:** Fasten the upper and lower portions of the handrails to the ladder assembly with 5/16" hardware (11060; 37021).

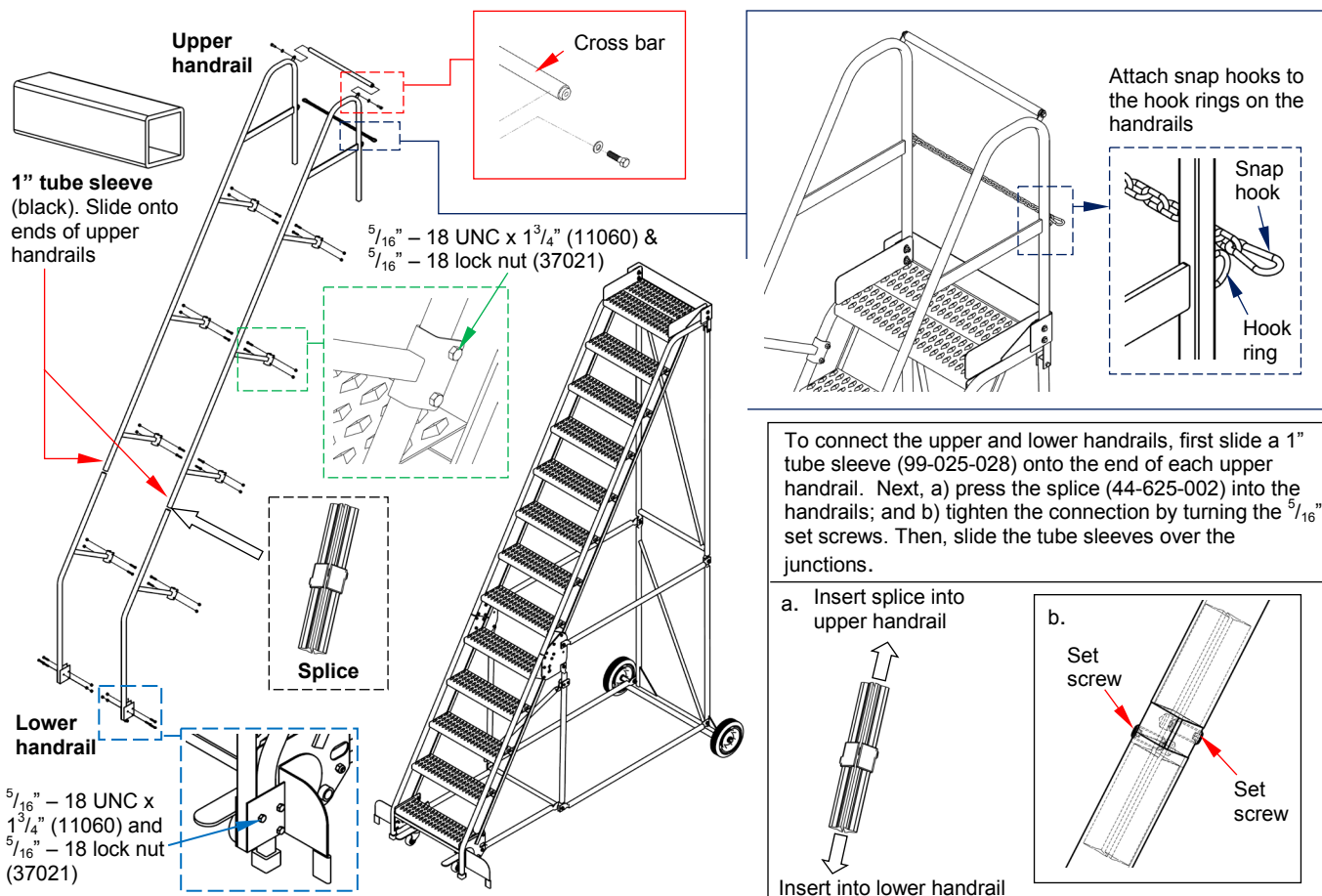

## RECORD OF SATISFACTORY CONDITION (THE “RECORD”)

Thoroughly inspect the ladder after assembling it but before putting it into service. Record the condition and appearance of each of the frame members (step weldment, back leg weldment, base support frame members), the handrails, outriggers, wheels and/or casters, (leg) caps, back platform frame and chain, and all fasteners (bolts, nuts, etc.). Thoroughly photograph the ladder from multiple angles. Include close range photographs of the rubber leg caps, casters and wheels, all labeling, and all handrail connections. Add the photographs to the record. Collate all photographs and writings into a single file. This file is a record of the ladder in satisfactory condition. Compare the results of all inspections to this Record to determine whether the ladder is in satisfactory condition. Do not use the ladder unless it is in satisfactory condition. Purely cosmetic changes, like damaged paint or powdercoat, are not changes from satisfactory condition. However, touchup paint should be applied as soon as damage occurs.

## NATIONAL STANDARDS

This product is a “mobile ladder stand” (MLS). [ANSI standard A14.7](#) (the “Standard”) applies to MLS’s. You should acquire a copy of the latest version of the standard. Follow all use and maintenance/care instructions provided in the Standard as well as all other provisions for MLS owners and users. If any content in this manual conflicts with any recommendations or mandatory provision(s) in the Standard, apply the provision(s) from the Standard. Vestil encourages you to immediately contact [Technical Service](#) if you discover any inconsistencies.

## USING THE LADDER

Review the [SAFETY INSTRUCTIONS](#) on p. 2 before using the ladder. **ONLY use the ladder on even, level, improved surfaces (concrete or asphalt).**

Inspect the ladder before each use for damage, such as unusual wear, deterioration, and corrosion. Tighten loose nuts. If a lock nut has been partially or completely unfastened, it must be replaced with a new lock nut.

***Make sure there are no children in the area where the ladder is used or stored.***

### Climbing the ladder:

ONLY use this ladder on solid, level ground. Never use the ladder on angled surfaces. The ladder must not wobble or lean while in use. Only climb the ladder when the steps and handrails are clean and dry.

Stand on the bottom step. The front legs of the ladder should automatically lower into contact with the ground as the caster brackets pivot upwards (caster brackets identified on [p. 9](#)). The rubber caps on the front legs (see [Step 1](#) on [p. 10](#)) must solidly contact the ground before climbing the ladder. The caps resist sliding movement. They are included to prevent the front end of the ladder from moving while they are in contact with the ground.

Face the ladder and grasp the handrails while ascending the steps. Do not lean against the handrails, the guardrails (around the platform), or the platform bar or chain. Do not lean over the handrails or guardrails. Users do not have to back down the steps and instead may grasp the handrails and walk forward (face away from the ladder) to descend the steps.

### Moving the ladder:

After using the ladder, the mechanism that brings the front casters into ground contact must be reset. Lift the front of the ladder while pressing down on one of the caster brackets. Caster brackets are identified on [p. 9](#).

Grasp the handrails and carefully push the ladder. Only try to move the ladder if you are able to comfortably lift the front end and can easily control the ladder.

### Storing the ladder

This ladder is designed for use both indoors and outdoors. However, it should only be stored indoors. The ladder should be considered in storage whenever it has been unused for 30 minutes or more.

## INSPECTIONS & MAINTENANCE

Inspect the unit as instructed. Inspections and all necessary repairs should be performed by qualified persons. Compare the results of each inspection to the [Record of Satisfactory Condition](#). Do not use the ladder unless every part is in satisfactory condition. If you have any questions about the condition of your ladder, contact the [Technical Service](#) department. The phone number is provided on the cover page of this manual. **Never make temporary repairs of damaged or missing parts.** Only use manufacturer-approved replacement parts to restore the ladder to satisfactory condition.

**Before each use** inspect the ladder for any sustained damage, such as unusual wear, deterioration, or corrosion. Look for loose connections. Tighten all loose connections. Whenever a lock nut is partially or completely unfastened, it must be replaced with a new lock nut. Check cotter pins at each end of the wheel axle, the wheels, and the square caps (99-024-027) for damage.

**Regular inspections — at least once per month** inspect the following items. Replace all parts not in satisfactory condition before returning the ladder to service. DO NOT continue to use the ladder if damage cannot be repaired.

- Handrails, guardrails, toeboard, back frame weldment (platform bar), snap hooks, and platform chains: Confirm that both handrails are solidly fastened to the step weldment and to the platform. Each handrail should be straight, rigid, and undamaged. Examine the guardrails around the platform for damage, bends, and cracks. Examine the

**[Continued from p. 15]**

platform bar and, if applicable, the chain and snap hooks. Confirm that the bar and chain are undamaged and securely fastened to the guard railing. Snap hooks should close automatically.

- Rear wheels (16-132-310): Check the wheels. They must not be significantly worn, i.e. must still have ~1/8" of tread. Wheels must not be cracked, warped, broken, etc. They should be vertical (not bent towards, or away from, the ladder) and roll smoothly. Examine the wheel axle and cotter pins (11053) for damage.
- Frame members (step weldment, back leg weldment, base supports), handrails, and all fasteners (bolts, nuts, pins): Inspect each frame member for damage. In particular, look for excessive wear, bends, cracks, warps, damaged welds, and looseness. All frame pieces should be square, rigid, and free of rust and corrosion. Remove rust and apply touch-up paint to the affected area. Check the areas where components are fastened/bolted together. Check for cracks around bolt holes, elongated bolt holes, etc.
- Square caps (99-024-027): Check the caps for cracks, tears, and wear. If either cap is not in satisfactory condition, install a replacement cap before returning the ladder to service. Even a moderate amount of wear can affect the performance of a cap.
- Outriggers and outrigger fasteners (bolts, nuts): Examine the outriggers (44-514-310 & 44-514-311). Both should be undamaged and be securely fastened to the step weldment. Both outriggers should make solid contact with the ground. The ladder should not wobble. Confirm that the caps on the outrigger legs are in satisfactory condition.

**Maintenance:** Regular maintenance is required for the ladder to function properly for as long as possible. In addition to correcting issues discovered during inspections, maintain the ladder in the following ways.

- Clean the ladder with a damp cloth to remove dirt and grime, especially from step surfaces. Let the ladder dry completely before returning it to service.
- Lubricate bolts as necessary for the rear wheels to rotate freely. DO NOT get lubricant on the bolt threads!
- Apply touchup paint wherever the finish is damaged. Apply touchup paint as soon as damage occurs.



## LABELING DIAGRAM

Each unit should be labeled as shown in the diagram. Label content and location are subject to change so your product might not be labeled exactly as shown. Compare the diagram below to your *Record of Satisfactory Condition*. If there are any differences between actual labeling and this diagram, contact *Technical Service*.

Replace all labels that are damaged, missing, or not easily readable (e.g. faded). To order replacement labels or to inquire whether your unit is properly labeled, contact the technical service and parts department online at [http://www.vestilmfg.com/parts\\_info.htm](http://www.vestilmfg.com/parts_info.htm) or by calling (260) 665-7586 and asking for the Parts Department.

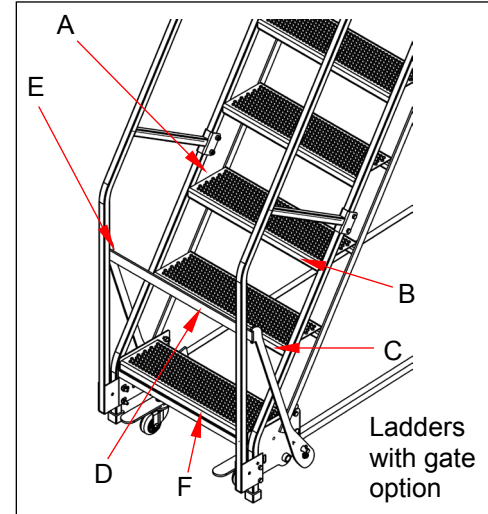
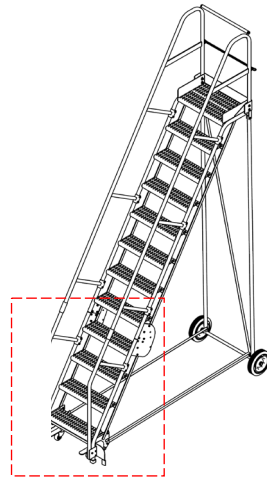
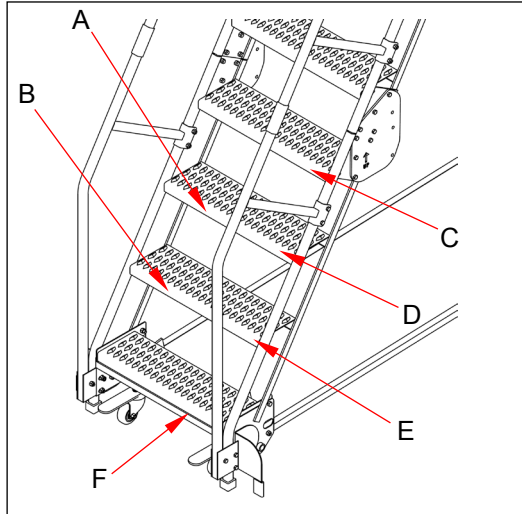

A: Label 821

<b>SAFETY FIRST</b>	<b>SEGURIDAD PRIMERO</b>
Read owners manual and all labels before using.	Lea el manual del propietario y todas las etiquetas antes del uso.

B: Label 287

MODEL/MODÉLO/MODÈLE _____	
STATIC CAPACITY (evenly distributed) _____	lbs.
LA CAPACIDAD CONSTANTE (distribuida uniformemente) _____	kgs.
CAPACITÉ STATIQUE (distribuée régulièrement) _____	kgs.
SERIAL/SERIE/SÉRIE _____	

287 REV 0812

C: Label 740

⚠ WARNING	⚠ ADVERTENCIA	⚠ AVERTISSEMENT
<ul style="list-style-type: none"> <li>• Do not use near live electric lines</li> <li>• Do not climb rails or lean over rails</li> <li>• Do not use if damaged or worn</li> <li>• Use ladder on level, smooth surfaces only</li> </ul>	<ul style="list-style-type: none"> <li>• No use cerca de líneas eléctricas</li> <li>• No se suba o se asome en la barandilla</li> <li>• No use si esta danado o gastado</li> <li>• Use la escalera en superficies a nivel y lisas</li> </ul>	<ul style="list-style-type: none"> <li>• Ne pas utiliser près des lignes électriques sous tension</li> <li>• Ne pas grimper sur ou vous pencher des rails</li> <li>• Ne pas utiliser si endommagée ou usagée</li> <li>• Utiliser l'échelle seulement sur des surfaces plates et lisses</li> </ul>

740

D: Label 729



E: Label 468

**AUTHORIZED PERSONNEL ONLY**

468 REV 0812

F: Label 998

**Step here to engage brake / Pise aqui para poner el freno**

998

## LIMITED WARRANTY

Vestil Manufacturing Corporation ("Vestil") warrants this product to be free of defects in material and workmanship during the warranty period. Our warranty obligation is to provide a replacement for a defective, original part covered by the warranty after we receive a proper request from the Warrantee (you) for warranty service.

### Who may request service?

Only a warrantee may request service. You are a warrantee if you purchased the product from Vestil or from an authorized distributor AND Vestil has been fully paid.

### Definition of "original part"?

An original part is a part used to make the product as shipped to the Warrantee.

### What is a "proper request"?

A request for warranty service is proper if Vestil receives: 1) a photocopy of the Customer Invoice that displays the shipping date; AND 2) a written request for warranty service including your name and phone number. Send requests by one of the following methods:

US Mail	Fax	Email
Vestil Manufacturing Corporation 2999 North Wayne Street, PO Box 507 Angola, IN 46703	(260) 665-1339 <u>Phone</u> (260) 665-7586	<a href="mailto:info@vestil.com">info@vestil.com</a> Enter "Warranty service request" in subject field.

In the written request, list the parts believed to be defective and include the address where replacements should be delivered. After Vestil receives your request for warranty service, an authorized representative will contact you to determine whether your claim is covered by the warranty. Before providing warranty service, Vestil will require you to send the entire product, or just the defective part (or parts), to its facility in Angola, IN.

### What is covered under the warranty?

The warranty covers defects in the following original, dynamic parts: motors, hydraulic pumps, motor controllers, and cylinders. It also covers defects in original parts that wear under normal usage conditions ("wearing parts"), such as bearings, hoses, wheels, seals, brushes, and batteries.

### How long is the warranty period?

The warranty period for original dynamic components is 90 days. For wearing parts, the warranty period is 90 days. Both warranty periods begin on the date Vestil ships the product to the Warrantee. If the product was purchased from an authorized distributor, the periods begin when the distributor ships the product. Vestil may, at its sole discretion, extend a warranty period for products shipped from authorized distributors by up to 30 days to account for shipping time.

### If a defective part is covered by the warranty, what will Vestil do to correct the problem?

Vestil will provide an appropriate replacement for any *covered* part. An authorized representative of Vestil will contact you to discuss your claim.

### What is not covered by the warranty?

The Warrantee (you) is responsible for paying labor costs and freight costs to return the product to Vestil for warranty service.

### Events that automatically void this Limited Warranty.

- Misuse;
- Negligent assembly, installation, operation or repair;
- Installation/use in corrosive environments;
- Inadequate or improper maintenance;
- Damage sustained during shipping;
- Collisions or other accidents that damage the product;
- Unauthorized modifications: Do not modify the product IN ANY WAY without first receiving written authorization from Vestil.

### Do any other warranties apply to the product?

Vestil Manufacturing Corp. makes no other express warranties. All implied warranties are disclaimed to the extent allowed by law. Any implied warranty not disclaimed is limited in scope to the terms of this Limited Warranty. Vestil makes no warranty or representation that this product complies with any state or local design, performance, or safety code or standard. Noncompliance with any such code or standard is not a defect in material or workmanship.

